

1 615946 Steering accelerator

Warning pictograms for safety risks and compulsory workwear



Required tools

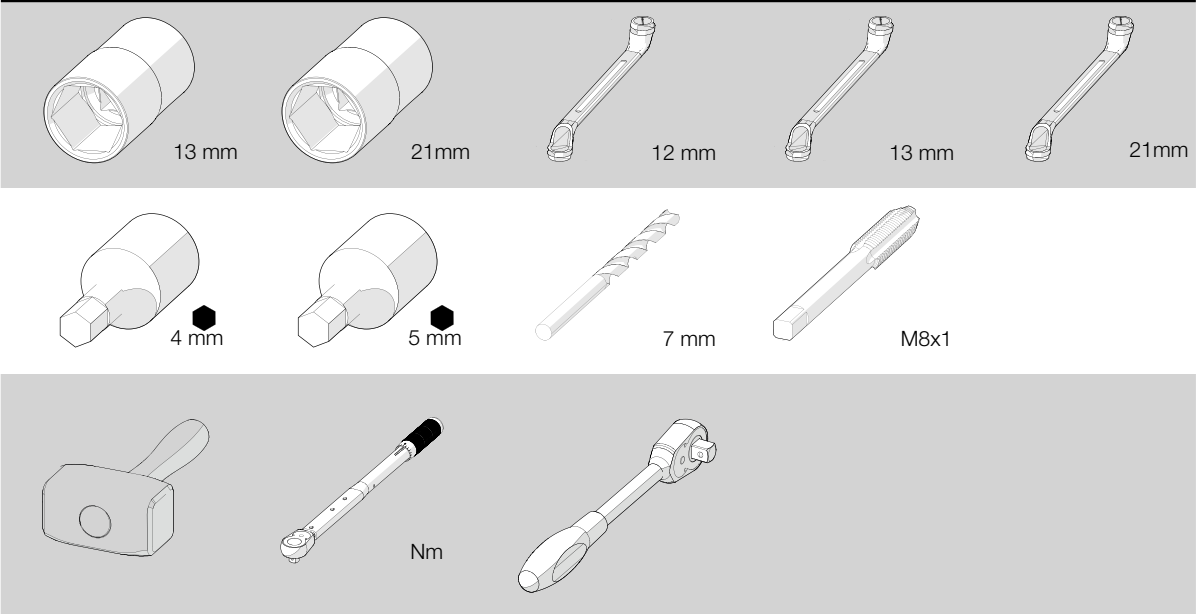
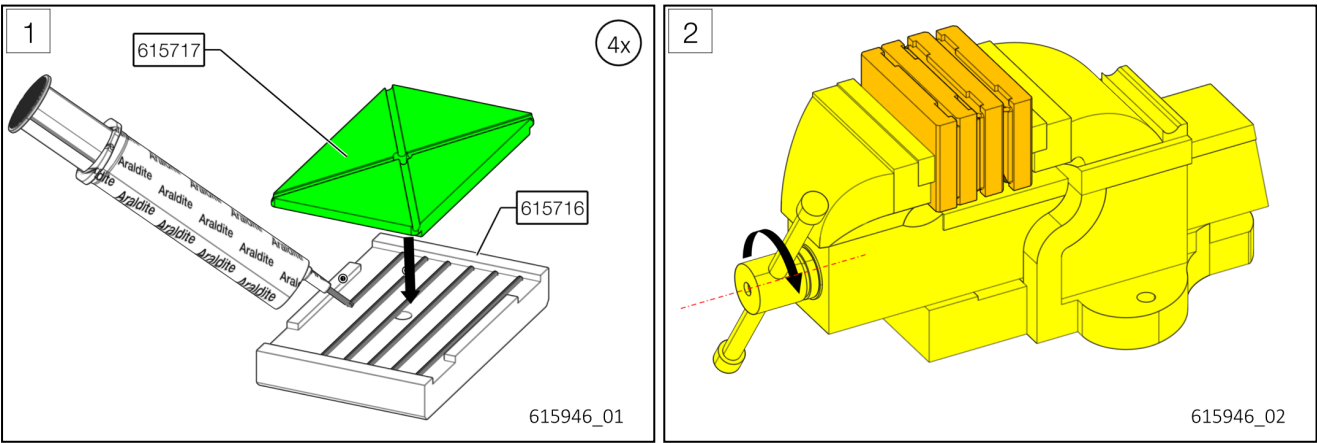

Table-1 Tools

Procedure

1. Carry out the next procedure.





Araldite 2014-1: Drying time: 25°C (3h) - 15°C (8h)

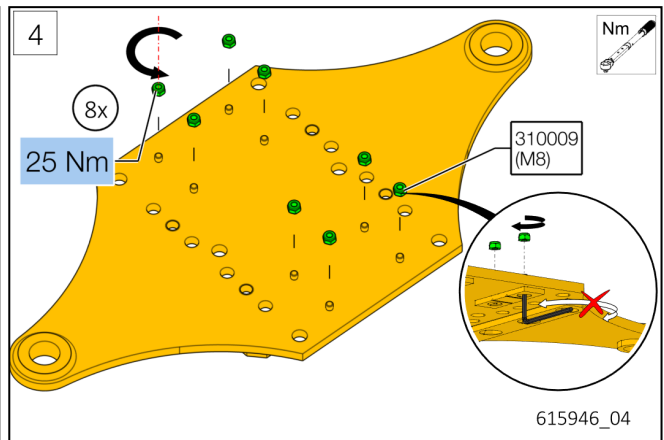
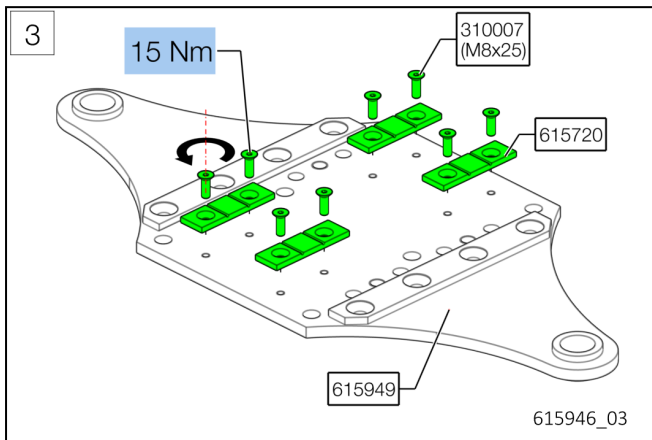

Keep the allen key, as shown in 4 and 6, at a fixed position while tightening the nuts!

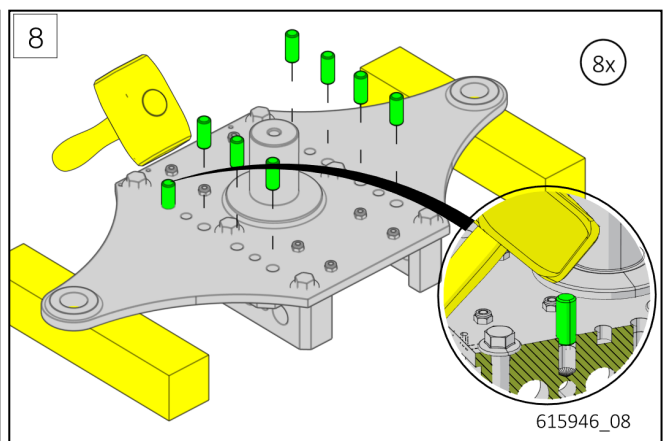
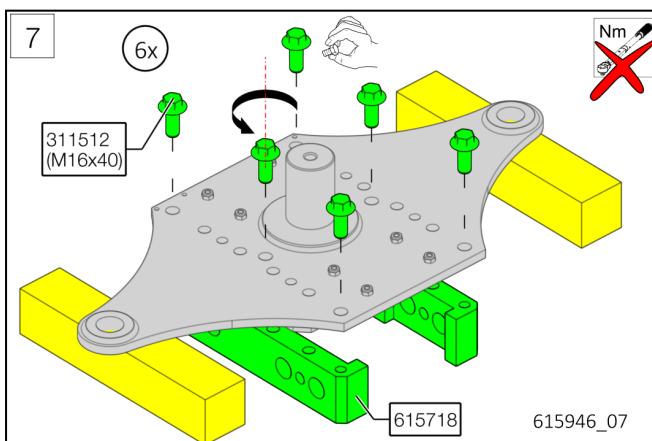
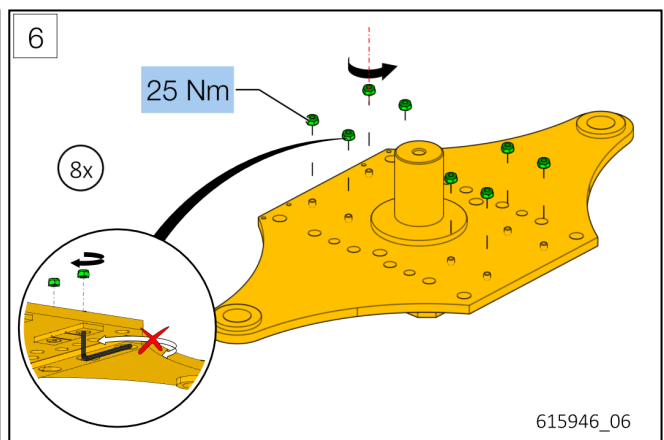
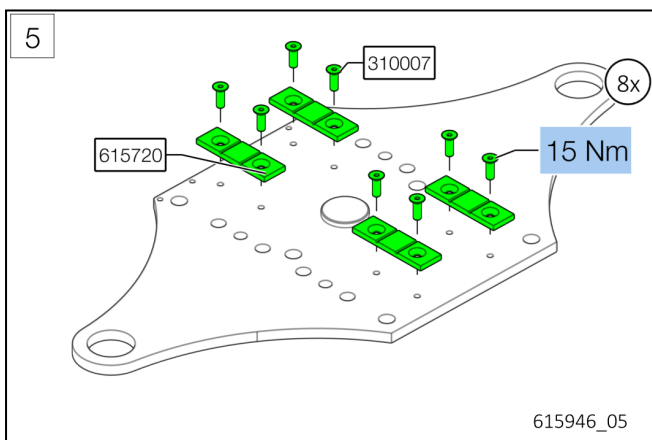

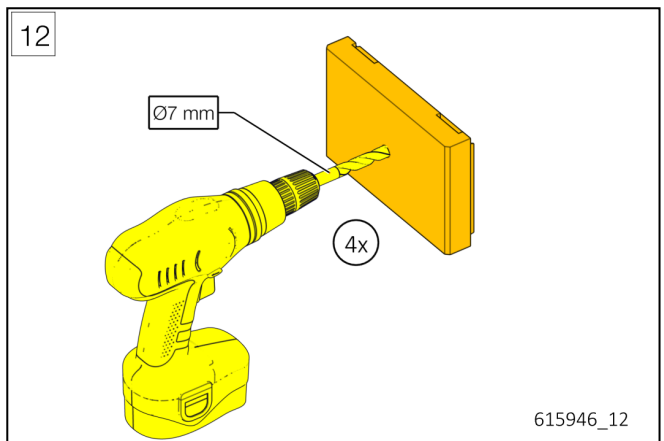
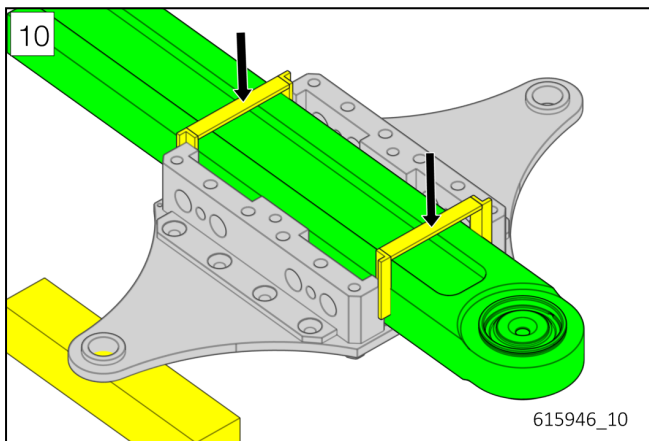
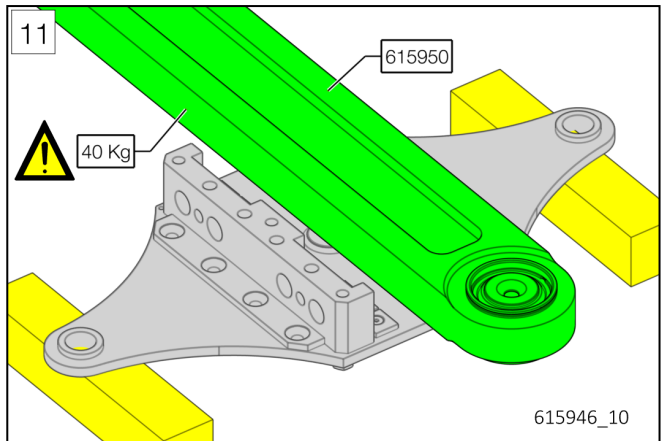
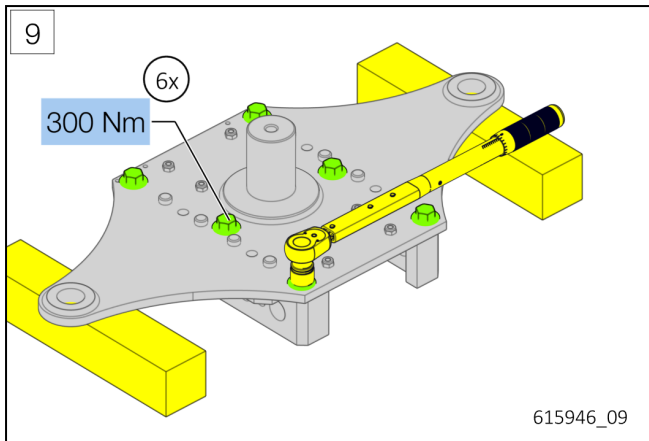

2. Carry out step 12 and 13 in case the threaded hole contains the araldite glue.

